



EASYPUMP® II

THE ELASTOMERIC PUMP SYSTEM FOR SHORT AND LONG-TERM
INFUSION THERAPY MAKING LIFE EASIER

EASYPUMP® II

DISPOSABLE ELASTOMERIC INFUSION PUMP SYSTEM



EASYPUMP® II

THE MANY BENEFITS OF AN EASY MOBILE MEDICAL TREATMENT



BENEFITS FOR PATIENTS

- Small and light (especially as therapy progresses)
- Carry Pouch enables discrete transport of the pump
- Allows patient faster discharge from hospital
- Helps to return to normal activities quicker

TOGETHER WITH THE RIGHT CHOICE OF THERAPY, PATIENTS' WELL-BEING IS OFTEN RELATED TO RECOVERING IN A FAMILIAR ATMOSPHERE. EASYPUMP II SUPPORTS THIS APPROACH.

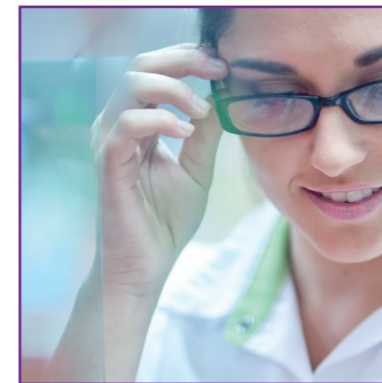

BENEFITS FOR PHARMACISTS

- Easy filling with low filling force
- Broad range of therapies (extensive list of drug stability data available)
- Preset parameters to ensure safety for hospital and home use
- No programming or rate changing necessary
- Integrated air venting and particle filter
- Fully latex-free product portfolio
- Minimal training required



BENEFITS FOR PHYSICIANS

- Versatile use for infusion therapies like chemotherapy and antibiotics
- Broad range of therapies (extensive list of drug stability data available)
- Suitable for intravenous, subcutaneous and epidural treatment
- Suitable for stationary and ambulatory use
- Preset parameters to ensure safety for both hospital and home use
- Safe, single-use system for clean and easy handling
- Fully latex-free product portfolio



BENEFITS FOR NURSES

- Easy maintenance, reduced workload
- Minimal training required
- Low filling force
- No programming or rate changing necessary
- No fuss with batteries or electric devices
- Integrated air venting and particle filter
- Kink-resistant tubing

Easypump® II is a mobile elastomeric infusion pump designed to give clinicians and nurses the option of delivering pre-determined amounts of short or long-term IV therapies to a patient in a continuous and accurate manner, either at the hospital, in an ambulatory setting or at their home.

It offers a broad product portfolio of different versions and features a clear coding system that helps to identify the version that best fits the patients needs.

Reduced Filling pressure

The elastomeric membrane has a silicone layer that stretches easily. As a result, the filling force is reduced by approximately 50 % in comparison to other elastomeric pumps. The high transparency of the membrane allows better visual inspection of the containing fluid.

Sliding Core

A movable / telescopic inner core allows axial expansion during filling (and vice versa contracting during deflation when delivery is running).

This allows consistent fluid delivery / higher flow rate accuracy and prevention of overdose especially for the delivery of toxic medication or when a narrow therapeutic dose is required.

With instant application, no waiting period is necessary to relax the pressure exerted by the bladder on the fluid inside.

Needle-free filling

Filling of Easypump® II is done with a Luer Lock syringe or Pharmacy filling machines.

Integrated Back-Check Valve

Avoids any reflux of fluids and chemical contamination.

Triangle Tubing

The Administration line has kink resistant tubing due to the triangle diameter design.

Air-Eliminating and Particle Filter (1.2 µm)

The filter also eliminates particles, which may come from incomplete preparation of drugs.

Fill Force Comparison¹

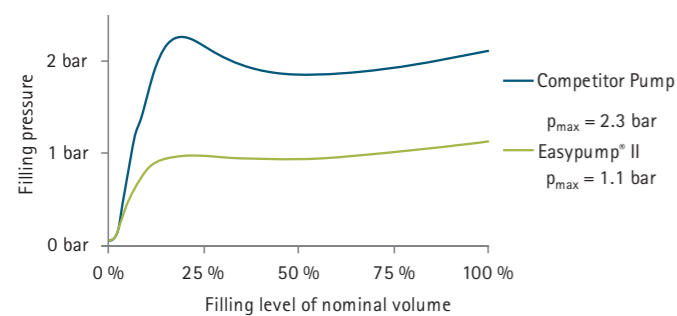

Reference: ¹Data on File

EASYPUMP® II

INSTRUCTIONS FOR PRIMING AND FILLING

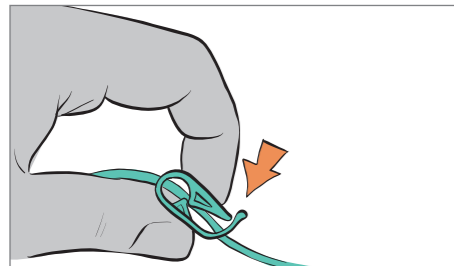

1. Close the clamp.

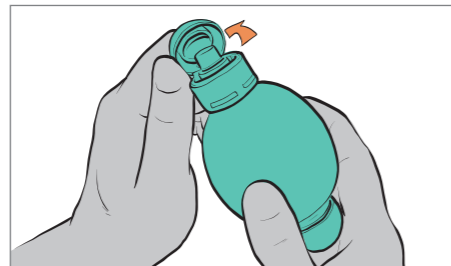

2. Flip open the comfort cap.

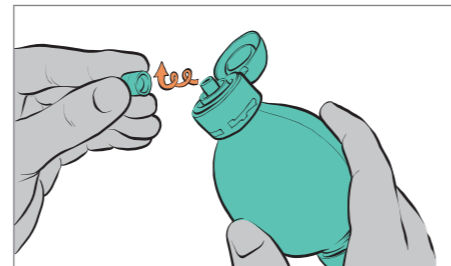

3. Twist off the closing cone from the filling port and place it on a sterile surface.

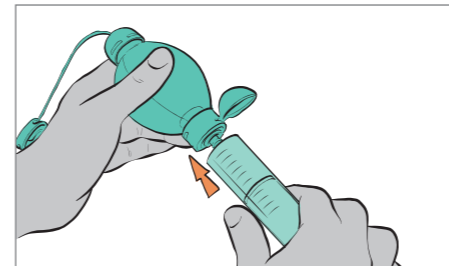

4. Attach the filling device to the filling port.

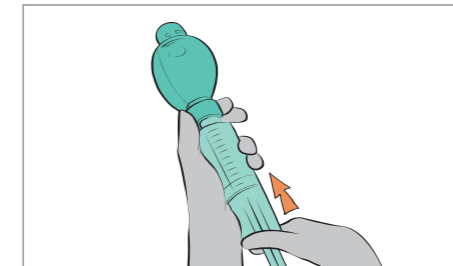

5. Inject diluent. Repeat as often as necessary.

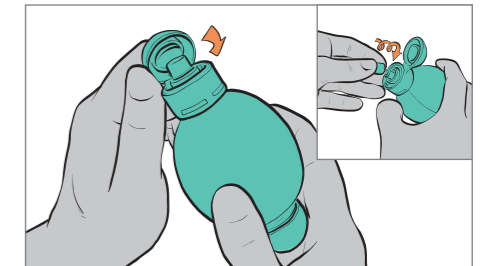

6. Remove the filling device from the filling port and close all caps.

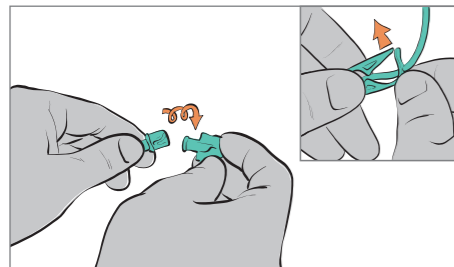

7. Open the closing cone of the patient connector. Release the clamp to prime the system.

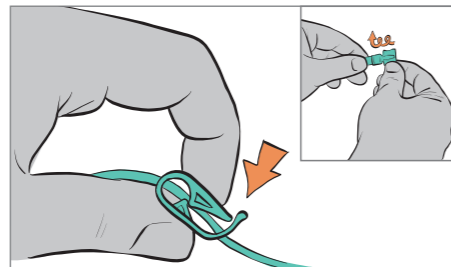

8. Close the clamp and reattach the closing cone of the patient connector.

Adding Medication

Use aseptic technique: Repeat steps 2-5 until required volume is achieved.

Note: Please make sure, closing cones of filling port and patient connector are properly closed after filling and prior to use!

HOW IT WORKS

Medication is delivered to the patient by positive pressure applied by the elastomeric membrane. The flow rate is determined by the combination of the flow regulation device (flow restrictor) and the positive pressure of the elastomeric membrane.

This pressure delivers the solution against the back-pressure of catheters and blood pressure in the veins.

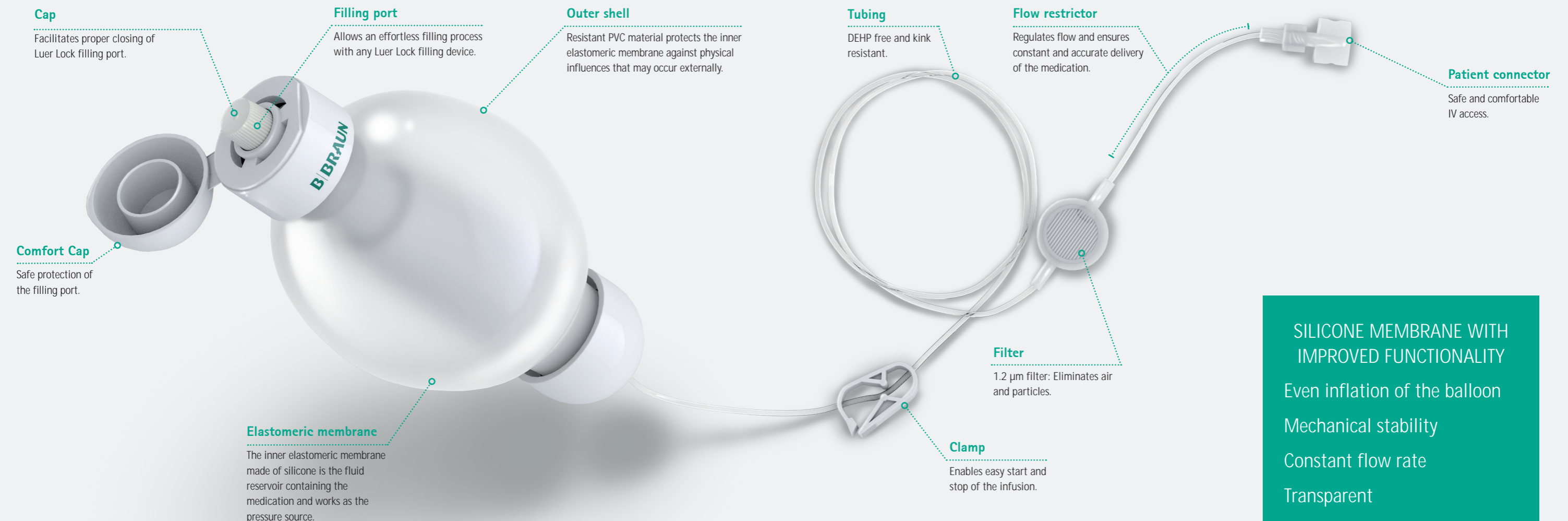

SILICONE MEMBRANE WITH IMPROVED FUNCTIONALITY

- Even inflation of the balloon
- Mechanical stability
- Constant flow rate
- Transparent
- 5-year shelf life

EASYPUMP® II

ORDERING INFORMATION

B. Braun Easypump® II ST-LT portfolio			
	Nominal filling volume	Nominal flow rate	Code No. (REF)
Easypump® II LT variants	60 ml	5 ml/h	4540002
	80 ml	5 ml/h	4540004
	125 ml	5 ml/h	4540006
	270 ml	10 ml/h	4540008
	60 ml	2 ml/h	4540010
	120 ml	4 ml/h	4540012
	400 ml	10 ml/h	4540014
	100 ml	2 ml/h	4540016
	270 ml	5 ml/h	4540018
	120 ml	2 ml/h	4540020
	100 ml	1.5 ml/h	4540024
	270 ml	4 ml/h	4540026
	400 ml	5 ml/h	4540022
	400 ml	4 ml/h	4540028
	65 ml	0.5 ml/h	4540030
	270 ml	2 ml/h	4540032
	300 ml	2 ml/h	4540034
	100 ml	0.5 ml/h	4540036
	270 ml	1 ml/h	4540038
Easypump® II ST variants	100 ml	200 ml/h	4540040
	250 ml	500 ml/h	4540042
	50 ml	50 ml/h	4540044
	100 ml	100 ml/h	4540046
	250 ml	250 ml/h	4540048
	250 ml	175 ml/h	4540050
	400 ml	200 ml/h	4540052
	500 ml	250 ml/h	4540054
	100 ml	50 ml/h	4540056
	400 ml	100 ml/h	4540058

All Easypump® II ST-LT variants are provided in boxes of 10 pieces